



EVROPSKÁ UNIE
Evropské strukturální a investiční fondy
Operační program doprava

Ministerstvo dopravy
Státní fond dopravní
infrastruktury





SO 10-40 ČÁST E.1.4

VÝŠKOVÝ SYSTÉM Bpv SOUŘADNICOVÝ SYSTÉM S-JTSK

Číslo změny:	Obsah změny:	Datum změny:
01	-	-
02	-	-
03	-	-

Objednatel:	 SPRÁVA ŽELEZNIČNÍ DOPRAVNÍ CESTY	Správa železniční dopravní cesty, s.o. Dlážděná 1003/7, 110 00 Praha 1 Stavební správa západ Sokolovská 278/1955, 190 00 Praha 9
-------------	---	---

Sdružení: „SEU + SP_Bezbariérové přístupy žst. Roudnice_P“	 SUDOP EU	 SUDOP PRAHA
--	---	--

Zpracovatel části:	 SUDOP PRAHA	Hlavní inženýr projektu: ING. STANISLAV JAROŠ
	SUDOP PRAHA a.s. Olšanská 1a, 130 80 Praha Tel.: +420 267 094 111 E-mail: praha@sudop.cz	Garant profese: -

Středisko: MOSTŮ			
Vedoucí střediska:	Odpovědný projektant SO, IO, PS:	Vypracoval:	Kontroloval:
ING. DANA WANGLER	ING. JAKUB GÖRINGER, Ph.D.	ING. JÁN BROS	ING. JIŘÍ ELBEL

Název akce:	REKONSTRUKCE NÁSTUPIŠŤ A ZŘÍZENÍ BEZBARIÉROVÝCH PŘÍSTUPŮ V ŽST. ROUDNICE N. L.		Číslo smlouvy:	17-091.640
			Projektový stupeň:	DSP
název PS/SO:	SO 10-40 ÚPRAVA PODCHODU V KM 476,674 (VČ. VÝTAHOVÝCH ŠACHET)		Datum:	10 / 2019
			Číslo části:	E.1.4
Název přílohy:	VÝKRES VÝZTUŽE NOVÉ ČÁSTI - DILATAČNÍ DÍL D1 - VÝKAZ VÝZTUŽE		Měřítko:	-
			Počet formátů:	-
			Číslo přílohy:	6.1.2

POZNÁMKY:

1. VÝZTUŽ JE VÁZÁNA NA MÍSTĚ.
2. SPONY DODAT JEDNOSTRANNĚ OTEVŘENÉ. VÁZÁNÍ SPON BUDE PROVEDENO PŘES KŘÍŽ
2. BETONOVÁ KRYCÍ VRSTVA c_{nom} JE DÁNA VZDÁLENOSTI MEZI POVRCHEM VÝZTUŽE NEJBLIŽŠÍM K POVRCHU BETONU (VČETNĚ SPON) A NEJBLIŽŠÍM POVRCHEM BETONU
3. VÝZTUŽ BUDE VODIVĚ PROPOJENA A NAPOJENA NA MĚŘÍCÍ BODY DLE TKP 124. MÍSTA PROPOJENÍ VÝZTUŽE STANOVÍ PRACOVNÍK SPECIALIZOVANÉ FIRMY.
4. PROFIL VÝZTUŽE NESMÍ BÝT OSLABEN ZÁPALLY A VRUBY PŘI POUŽITÍ BODOVÉHO SVARU
5. VEŠKERÁ BETONÁŘSKA VÝZTUŽ VYSTUPUJÍCÍ Z PRACOVNÍCH SPAR, KTERÁ NEBUDE ZABETONOVÁNA DO 8 TÝDNŮ, SE OCHRÁNÍ V CELÉ VYSTUPUJÍCÍ DÉLCE PROTIKOROZNÍM NÁTĚREM
6. V MÍSTECH SNÍŽENÉHO KRYTÍ BUDE BETONÁŘSKÁ VÝZTUŽ OPATŘENA EPOXIDOVÝM NÁTĚREM
7. DISTANČNÍ PODLOŽKY - 4 ks/m²
8. VÝKRES VÝZTUŽE VIZ PŘÍLOHA 6.1.1.1 A 6.1.1.2

MATERIÁL - OCEL:

B500B

OCEL

MATERIÁL - BETON:

ZÁKLAD

C25/30

DŘÍK

C30/37

KRYTÍ VÝZTUŽE

NOMINÁLNÍ KRYCÍ VRSTVA $c_{nom} = 50$ mm

MINIMÁLNÍ KRYCÍ VRSTVA $c_{min} = 40$ mm

SCHÉMA ZNAČENÍ PŘESAHOŮ



SCHÉMA ROZMÍSTĚNÍ SPON

11,1 ks/m² - RASTR 300x300mm

22,22 ks/m² - RASTR 300x150mm

44,44 ks/m² - RASTR 150x150mm

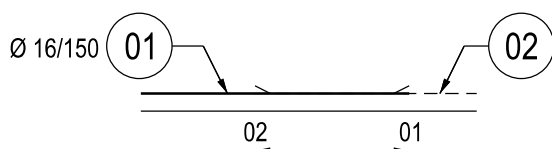

SCHÉMA KRYTÍ A VÁZÁNÍ SPON



SCHÉMA OHYBU VÝZTUŽE	
SCHÉMA KÓTOVÁNÍ PRUTŮ DLE ČSN EN ISO 3766	
OHYBY, HÁKY, SMYČKY: D	
d_s (mm)	
≤ 16 mm	> 16 mm
4 d_s	7 d_s
ROZMĚRY VÝZTUŽE V mm	
VÝZTUŽ KÓTOVÁNA NA VNĚJŠÍ ROZMĚR DLE ČSN EN ISO 3766 (METODA A)	

VÝKAZ VÝZTUŽE

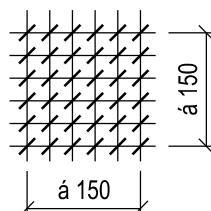
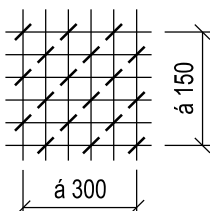
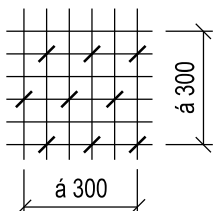
POL.	Ø [mm]	POČET [ks]	JEDNOTL. DÉLKA [m]	CELKOVÁ DÉLKA [m]	CELKOVÁ HMOTN. [kg]
01	16	16	5,27	84,32	133.06
02	16	17	8,66	147,22	232.31
03	16	4	6,96	27,84	43.93
04	16	13	6,00	78,00	123.08
05	20	2	7,26	14,52	35.81
06	16	13	5,85	76,05	120.01
07	16	64	7,38	472,32	745.32
08	20	42	6,57	275,94	680.47
09	12	1	8,01	8,01	7.11
10	12	1	5,23	5,23	4.64
11	16	16	9,67	154,72	244.15
12	20	17	12,43	211,31	521.09
13	16	19	5,09	96,71	152.61
14	16	19	3,22	61,18	96.54
15	16	21	3,16	66,36	104.72
16	16	32	4,24	135,68	214.10
17	16	3	1,74	5,22	8.24
18	16	3	4,24	12,72	20.07
19	16	17	4,18	71,06	112.13
20	16	30	6,11	183,30	289.25
21	16	4	6,72	26,88	42.42
22	16	15	2,50	37,50	59.17
23	16	30	4,07	122,10	192.67
24	16	12	5,41	64,92	102.44
25	16	23	3,90	89,70	141.55
26	12	8	4,36	34,88	30.97
27	16	7	7,99	55,93	88.26
28	12	8	2,33	18,64	16.55
29	16	7	3,22	22,54	35.57
30	16	21	1,78	37,38	58.99
31	16	3	5,45	16,35	25.80
32	16	7	2,00	14,00	22.09
33	16	15	2,94	44,10	69.59
34	16	24	4,39	105,36	166.26
35	16	10	3,29	32,90	51.92
36	16	32	1,52	48,64	76.75
37	16	142	1,21	171,82	271.13
38	16	18	1,59	28,62	45.16
39	16	26	7,80	202,80	320.02
40	20	21	7,57	158,97	392.02
41	20	16	9,52	152,32	375.62
42	20	17	12,27	208,59	514.38
43	12	48	1,90	91,20	80.99
44	12	3	2,02	6,06	5.38
45	12	3	1,97	5,91	5.25
46	12	17	1,66	28,22	25.06
47	16	18	4,04	72,72	114.75
48	16	18	3,75	67,50	106.51
49	16	46	6,10	280,60	442.79
50	16	63	2,95	185,85	293.27
51	16	16	5,87	93,92	148.21
52	16	17	8,52	144,84	228.56

POL.	Ø [mm]	POČET [ks]	JEDNOTL. DÉLKA [m]	CELKOVÁ DÉLKA [m]	CELKOVÁ HMOTN. [kg]
53	16	16	5,32	85,12	134.32
54	16	32	3,41	109,12	172.19
55	16	32	4,66	149,12	235.31
56	20	4	5,49	21,96	54.15
57	16	32	1,55	49,60	78.27
58	16	32	5,84	186,88	294.90
59	16	32	1,82	58,24	91.90
60	16	32	2,49	79,68	125.74
61	16	32	2,80	89,60	141.39
62	16	32	2,94	94,08	148.46
63	16	32	3,35	107,20	169.16
64	16	32	2,32	74,24	117.15
65	16	32	1,43	45,76	72.21
66	16	15	PROM.	18,53	29.24
67	16	19	2,87	54,53	86.05
68	16	17	PROM.	19,90	31.40
69	16	17	7,99	135,83	214.34
70	16	2	1,99	3,98	6.28
71	10	76	1,06	80,56	49.71
72	10	16	PROM.	16,54	10.21
73	20	42	5,10	214,20	528.22
74	16	18	5,73	103,14	162.75
75	16	2	1,88	3,76	5.93
76	16	2	3,93	7,86	12.40
77	16	2	1,87	3,74	5.90
78	16	18	4,76	85,68	135.20
79	16	18	3,46	62,28	98.28
80	16	18	1,11	19,98	31.53
81	16	64	3,16	202,24	319.13
82	16	42	3,86	162,12	255.83
83	16	11	1,73	19,03	30.03
84	16	15	6,32	94,80	149.59
85	16	15	2,88	43,20	68.17
86	16	9	4,15	37,35	58.94
87	16	15	1,86	27,90	44.03
88	16	9	1,16	10,44	16.47
89	16	21	4,89	102,69	162.04
90	20	21	3,28	68,88	169.86
91	16	15	2,53	37,95	59.89
92	16	15	2,99	44,85	70.77
93	20	2	3,18	6,36	15.68
94	16	15	2,57	38,55	60.83
95	16	7	3,35	23,45	37.00
96	12	4	1,68	6,72	5.97
97	12	4	5,66	22,64	20.10
98	16	10	2,99	29,90	47.18
99	16	10	4,41	44,10	69.59
100	16	40	1,05	42,00	66.28
101	16	12	2,77	33,24	52.45
102	16	10	3,30	33,00	52.07
103	16	20	5,00	100,00	157.80
105	16	30	5,71	171,30	270.31

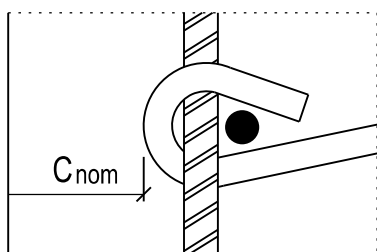
VÝKAZ VÝZTUŽE

POL.	Ø [mm]	POČET [ks]	JEDNOTL. DÉLKA [m]	CELKOVÁ DÉLKA [m]	CELKOVÁ HMOTN. [kg]
106	10	140	1,08	151,20	93.29
107	12	6	4,51	27,06	24.03
108	16	40	1,58	63,20	99.73
109	16	38	2,70	102,60	161.90
110	12	63	1,16	73,08	64.90
111	16	16	PROM.	12,36	19.50
112	10	26	1,09	28,34	17.49
113	16	13	1,25	16,25	25.64
114	16	20	2,90	58,00	91.52
115	16	20	2,75	55,00	86.79
116	16	28	2,09	58,52	92.34
118	16	9	1,75	15,75	24.85
119	16	13	6,91	89,83	141.75
120	16	15	6,46	96,90	152.91
121	16	20	2,19	43,80	69.12
122	16	20	4,03	80,60	127.19
123	16	20	2,46	49,20	77.64
124	16	20	3,44	68,80	108.57
125	16	20	5,03	100,60	158.75
126	16	20	4,28	85,60	135.08
127	16	20	1,12	22,40	35.35
128	16	20	1,21	24,20	38.19
129	16	21	4,89	102,69	162.04
130	16	13	1,15	14,95	23.59
131	10	20	0,64	12,80	7.90
132	16	40	3,61	144,40	227.86
133	16	21	2,68	56,28	88.81
134	12	2	0,97	1,94	1.72
135	12	2	1,53	3,06	2.72
136	12	2	1,87	3,74	3.32
137	16	2	7,79	15,58	24.59
138	20	2	3,18	6,36	15.68
139	10	16	PROM.	17,70	10.92
140	10	14	PROM.	15,54	9.59
141	20	4	4,98	19,92	49.12
142	10	6	1,50	9,00	5.55
143	12	3	1,75	5,25	4.66
151	10	135	0,58	78,30	48.31
152	10	365	0,56	204,40	126.11
153	10	175	0,52	91,00	56.15
154	10	65	0,48	31,20	19.25
155	10	1491	0,53	790,23	487.57
156	8	65	0,48	31,20	12.32
157	10	945	0,43	406,35	250.72
158	8	40	0,54	21,60	8.53
159	8	22	0,50	11,00	4.35
160	10	165	0,41	67,65	41.74
168	16	19	4,25	80,75	127.42

CELKOVÁ HMOTNOST [kg]: 17608.45

SCHÉMA VÝZTUŽE



SCHÉMA VÝZTUŽE



SCHÉMA VÝZTUŽE

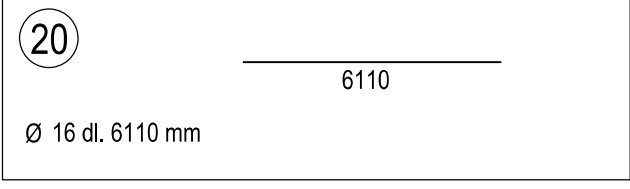
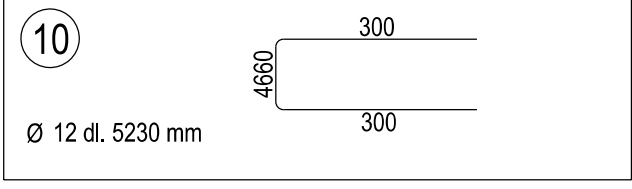
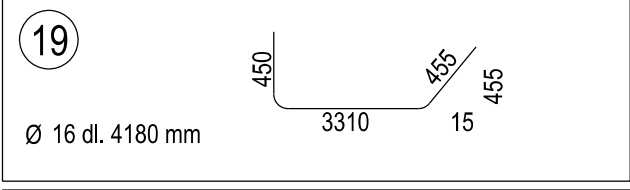
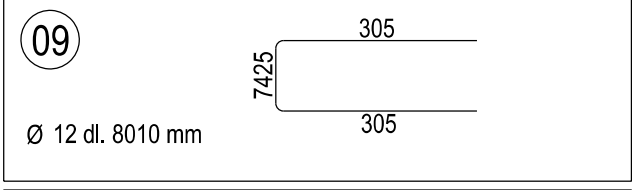
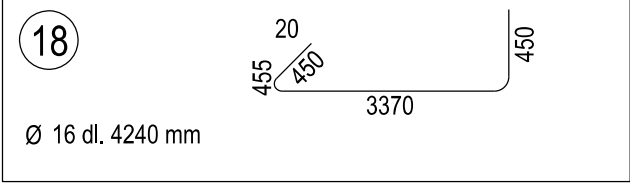
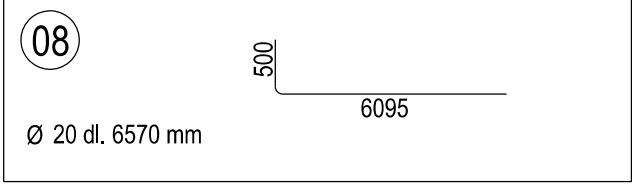
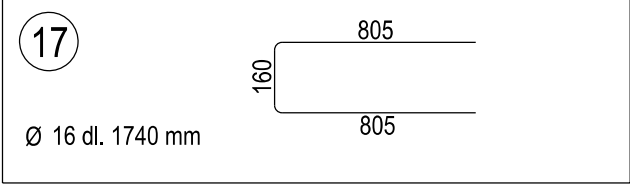
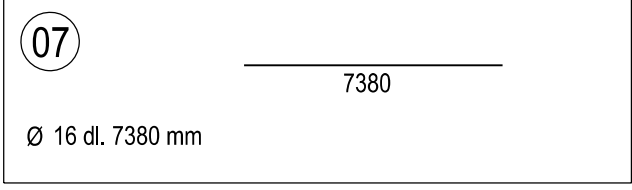
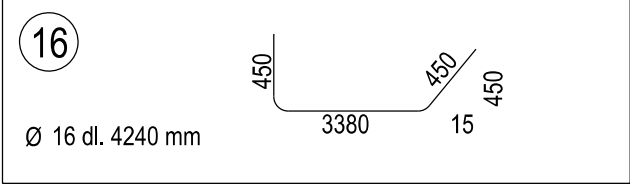
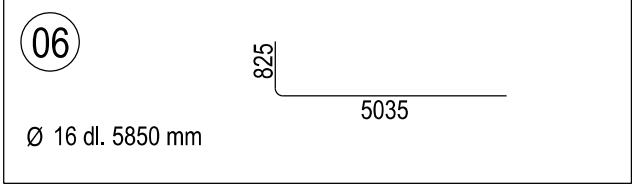
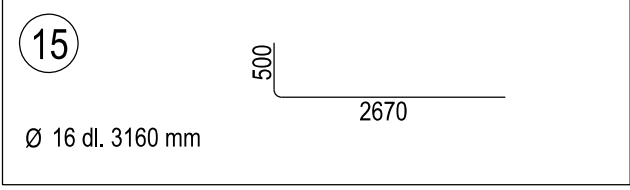
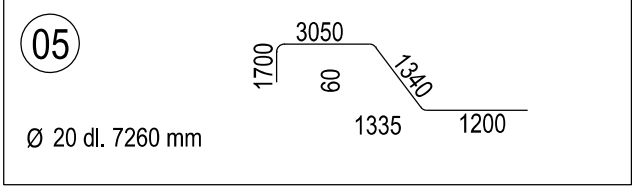
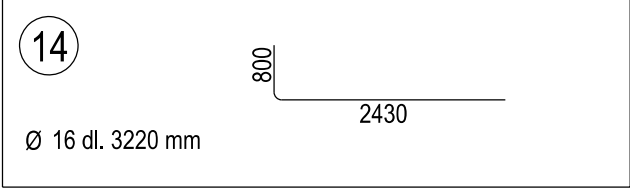
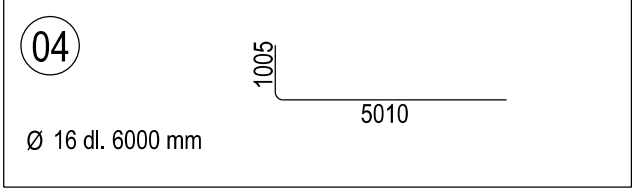
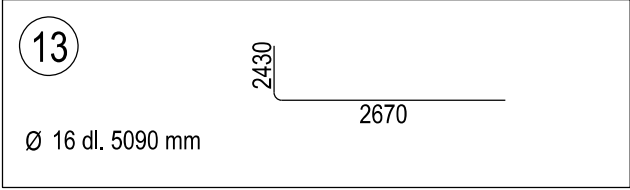
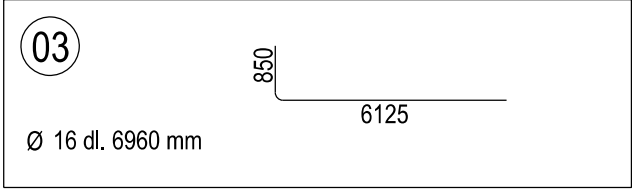
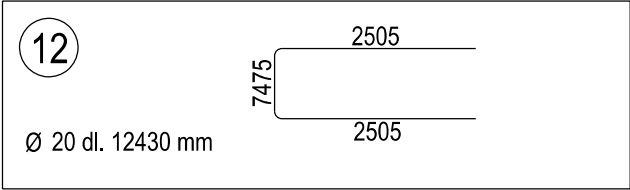
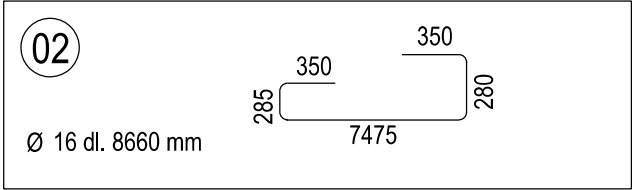
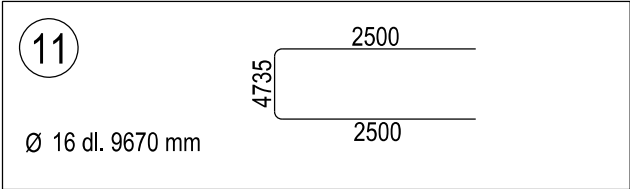
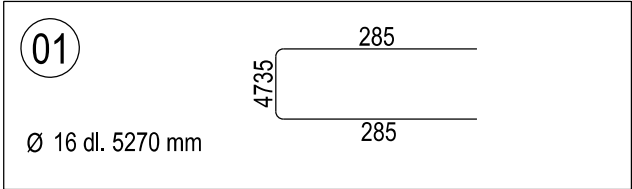

VÝZTUŽ KÓTOVÁNA NA VNĚJŠÍ ROZMĚR DLE ČSN EN ISO 3766 (METODA A)

SCHÉMA VÝZTUŽE

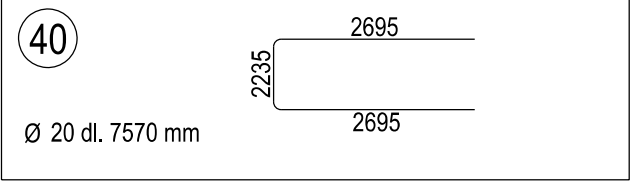
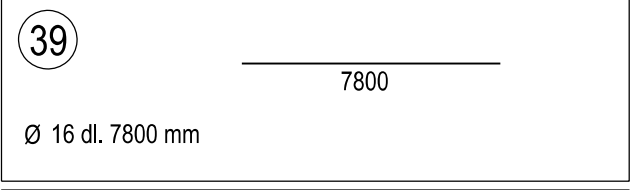
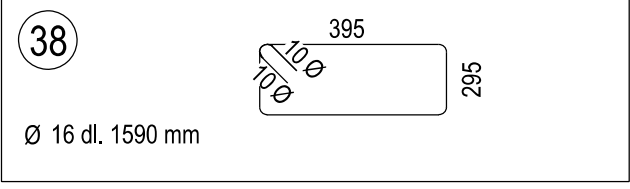
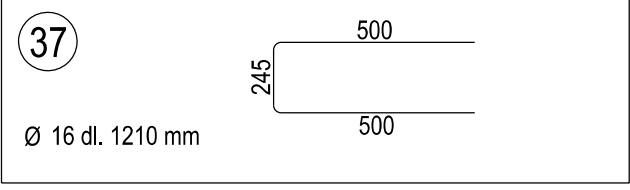
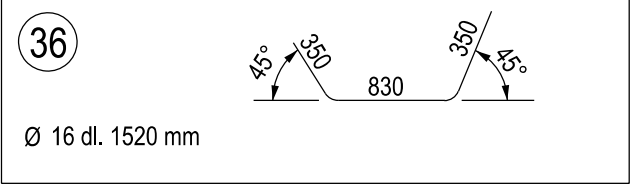
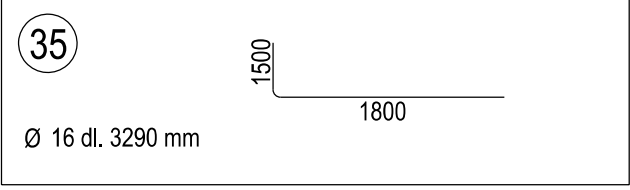
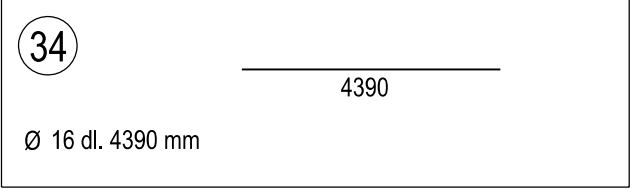
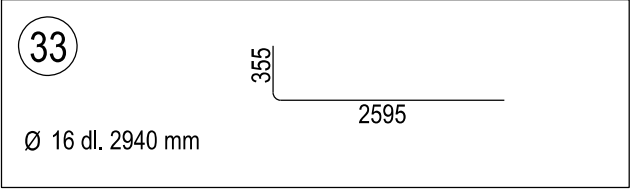
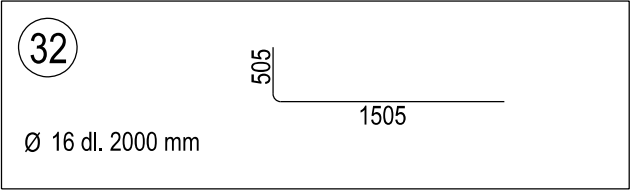
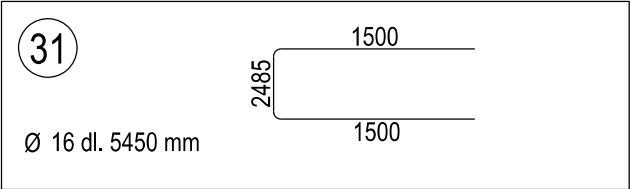
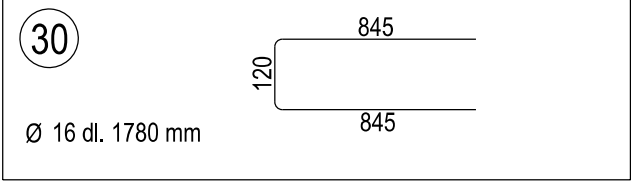
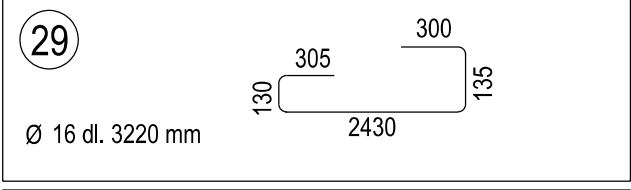
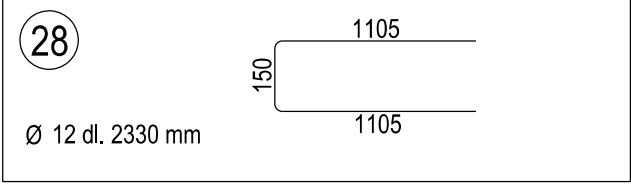
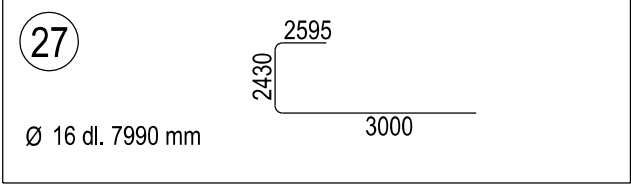
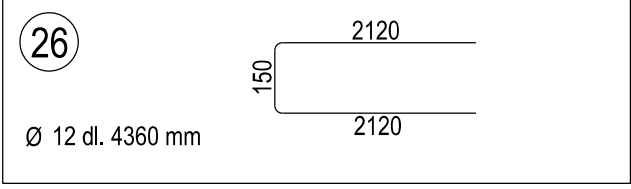
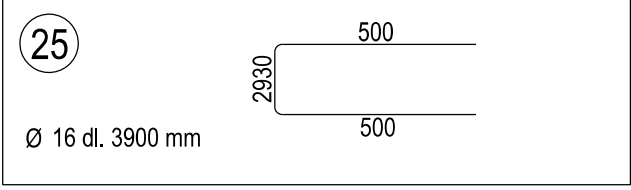
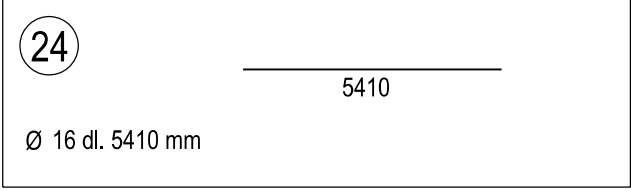
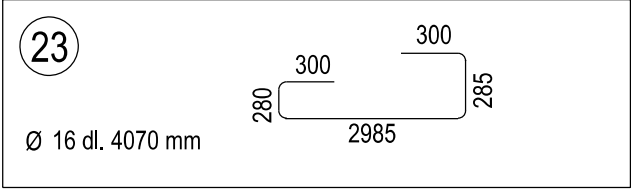
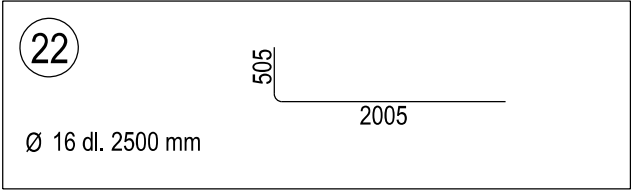
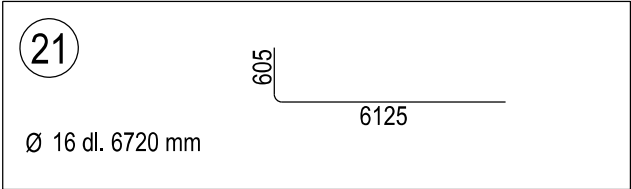
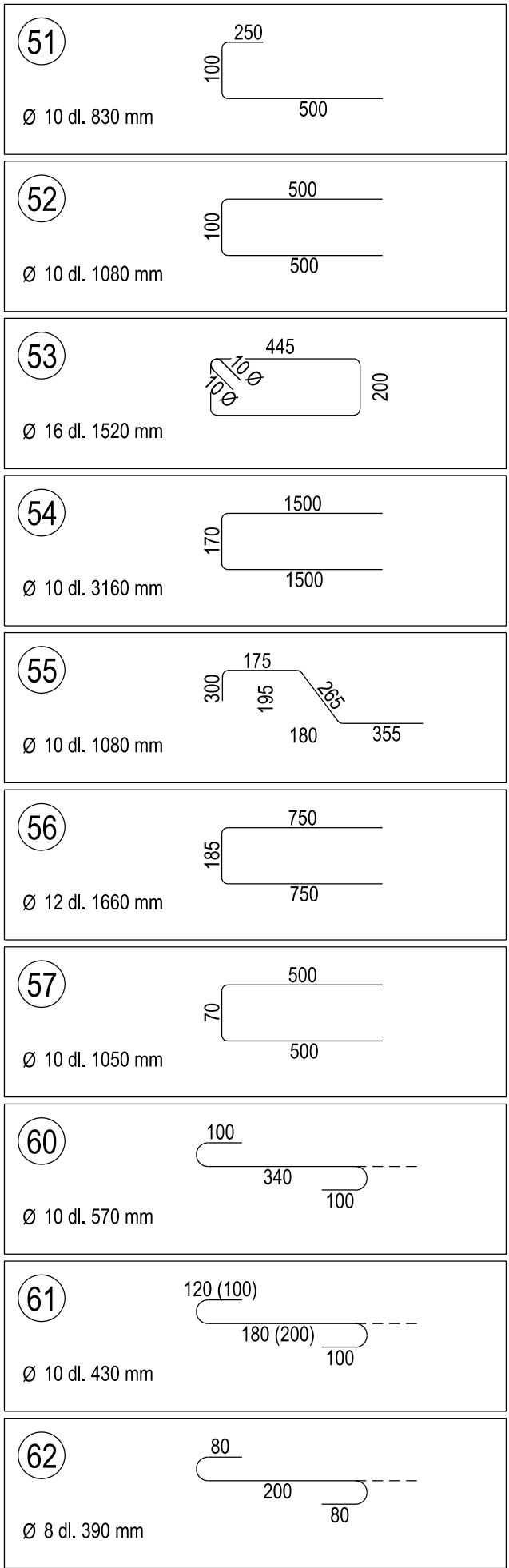
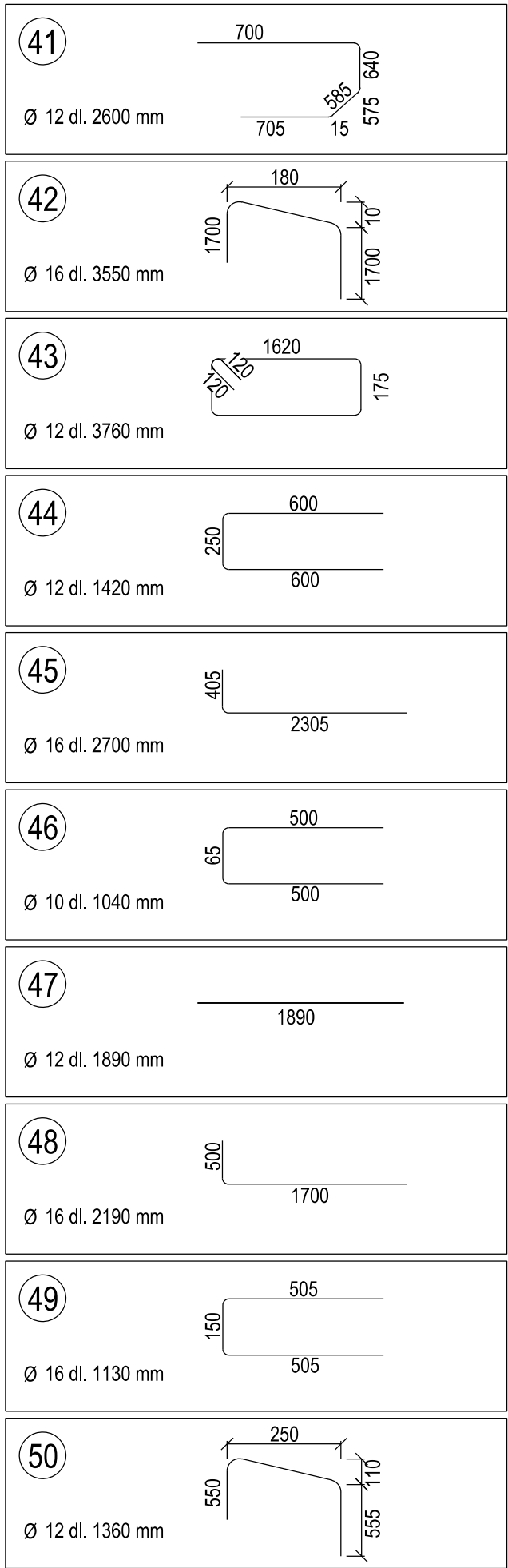
61

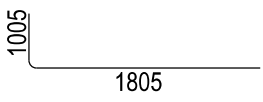

Ø 16 dl. 2800 mm

62

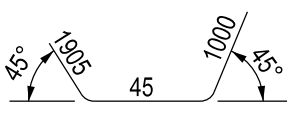

Ø 16 dl. 2940 mm

63

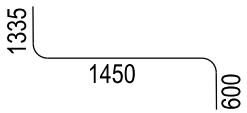

Ø 16 dl. 3350 mm

64

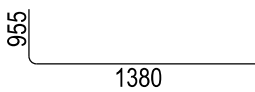

Ø 16 dl. 2320 mm

65

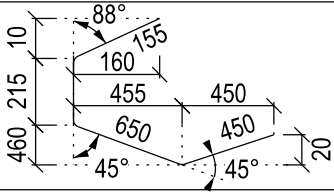

Ø 16 dl. 1430 mm

66

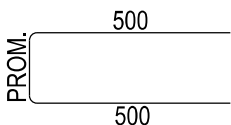

Ø 16 dl. PROM.

67

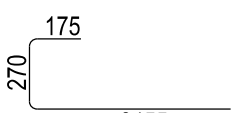

Ø 16 dl. 2870 mm

68

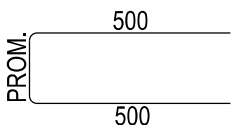

Ø 16 dl. PROM. mm

69

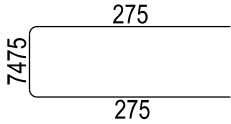

Ø 16 dl. 7990 mm

70

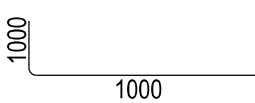

Ø 16 dl. 1990 mm

71

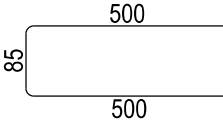

Ø 10 dl. 1060 mm

72

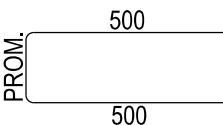

Ø 10 dl. PROM. mm

73

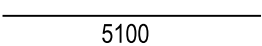

Ø 20 dl. 5100 mm

74

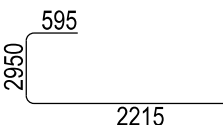

Ø 16 dl. 5730 mm

75

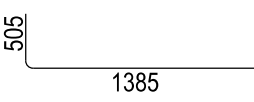

Ø 16 dl. 1880 mm

76

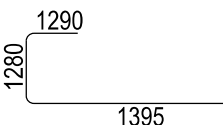

Ø 16 dl. 3930 mm

77

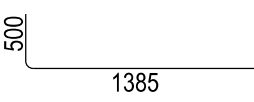

Ø 16 dl. 1870 mm

78



Ø 16 dl. 4760 mm

79

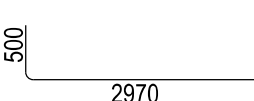

Ø 16 dl. 3460 mm

80

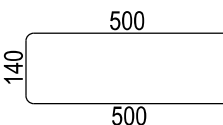

Ø 16 dl. 1110 mm

SCHÉMA VÝZTUŽE



SCHÉMA VÝZTUŽE

101

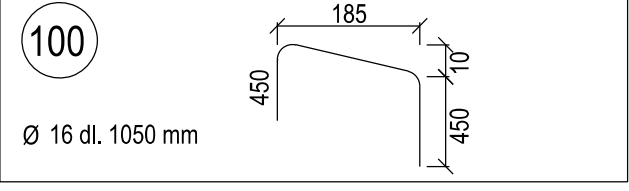
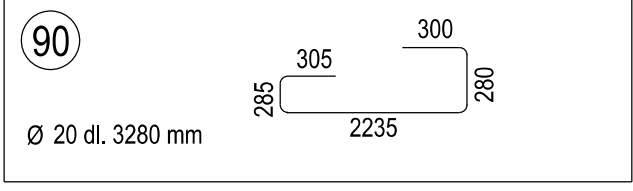
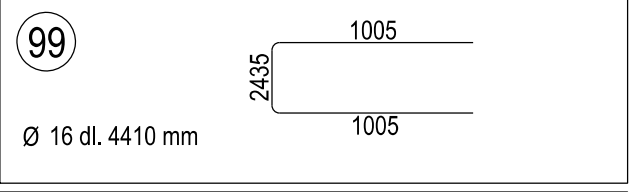
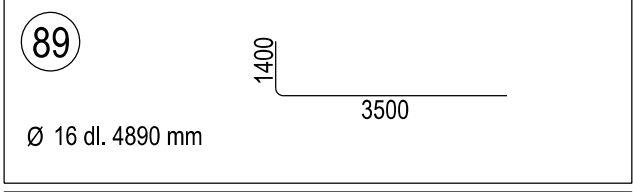
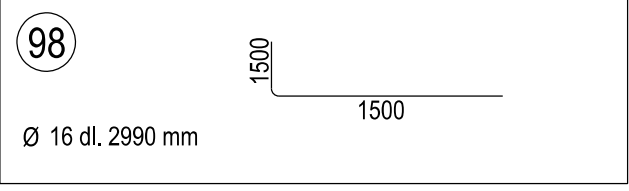
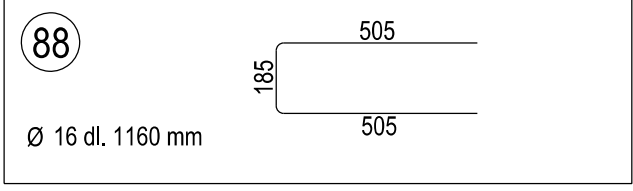
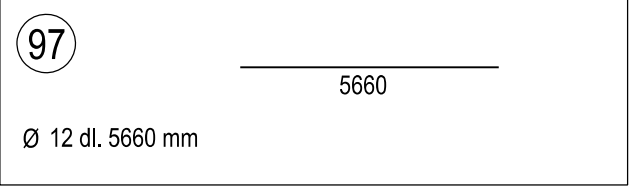
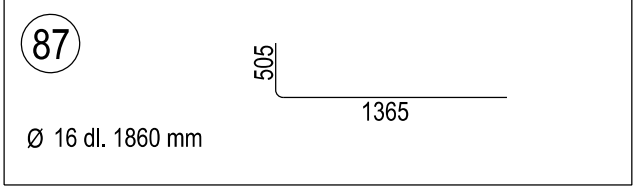
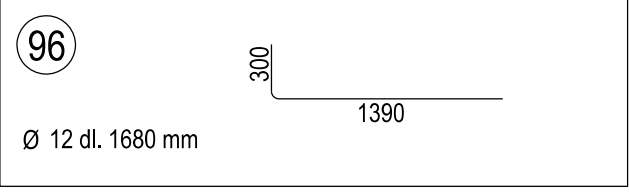
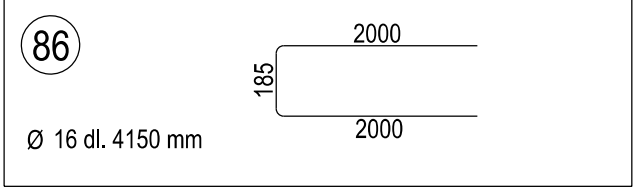
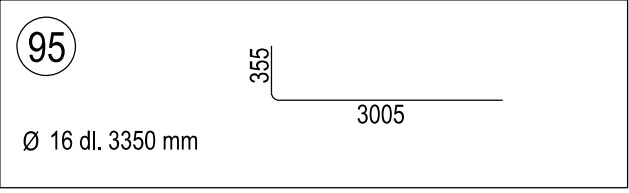
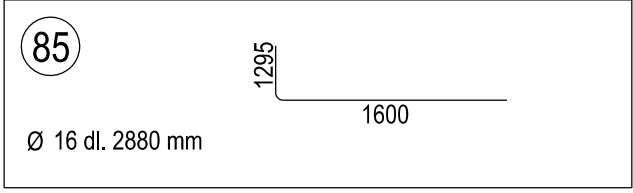
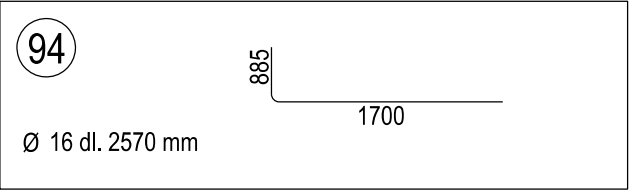
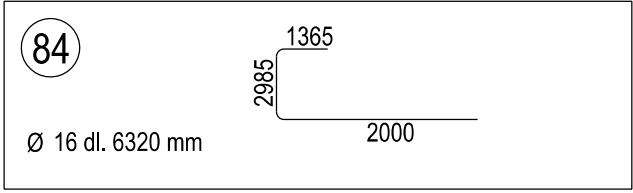
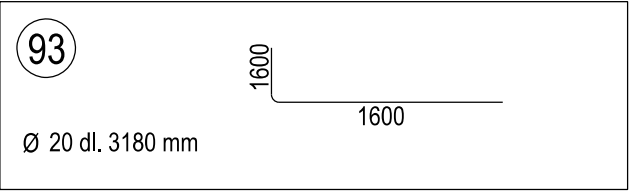
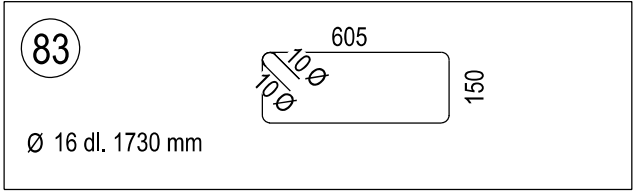
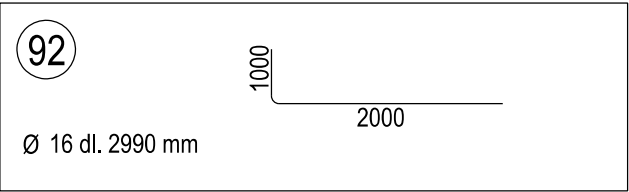
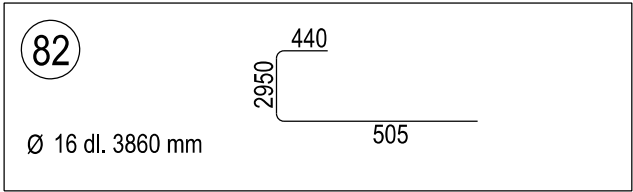
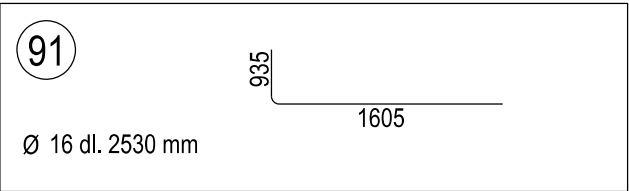
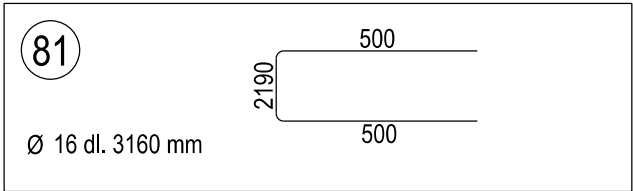

Ø 16 dl. 2770 mm

112

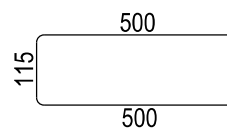

Ø 10 dl. 1090 mm

102



Ø 16 dl. 3300 mm

113

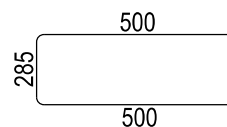

Ø 16 dl. 1250 mm

103

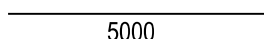

Ø 16 dl. 5000 mm

114

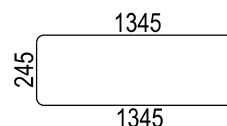

Ø 16 dl. 2900 mm

105

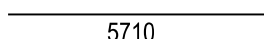

Ø 16 dl. 5710 mm

115

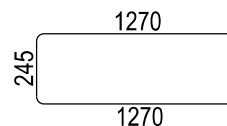

Ø 16 dl. 2750 mm

106

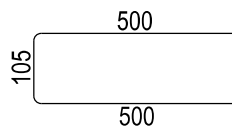

Ø 10 dl. 1080 mm

116

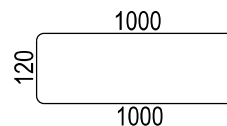

Ø 16 dl. 2090 mm

107

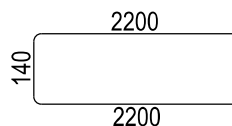

Ø 12 dl. 4510 mm

118

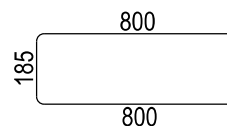

Ø 16 dl. 1750 mm

108

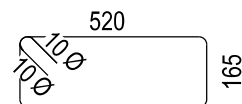

Ø 16 dl. 1580 mm

119

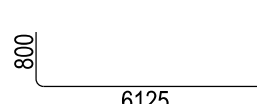

Ø 16 dl. 6910 mm

109

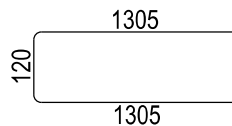

Ø 16 dl. 2700 mm

120

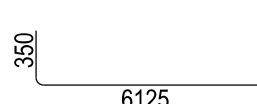

Ø 16 dl. 6460 mm

110

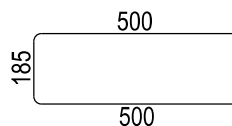

Ø 12 dl. 1160 mm

121

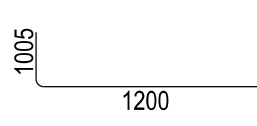

Ø 16 dl. 2190 mm

111

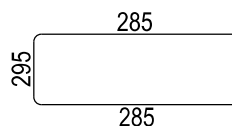

Ø 16 dl. 386 mm

122

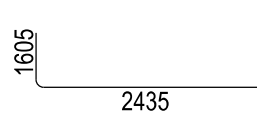

Ø 16 dl. 4030 mm

SCHÉMA VÝZTUŽE



SCHÉMA VÝZTUŽE

143

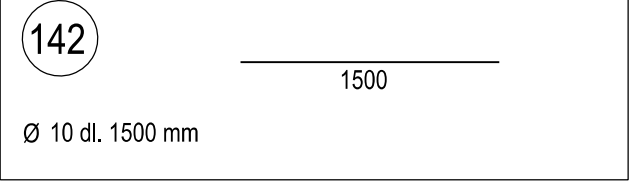
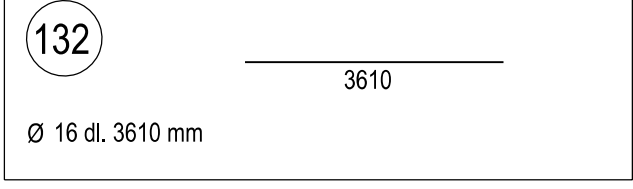
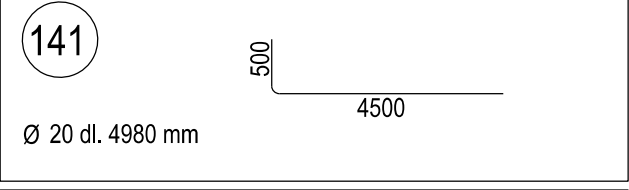
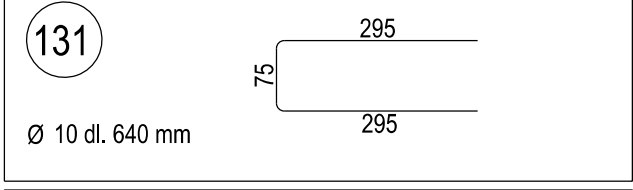
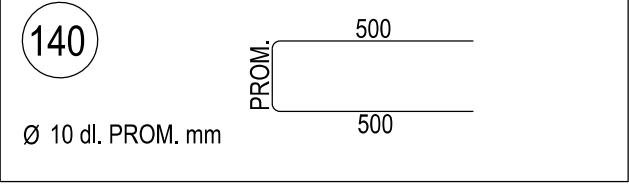
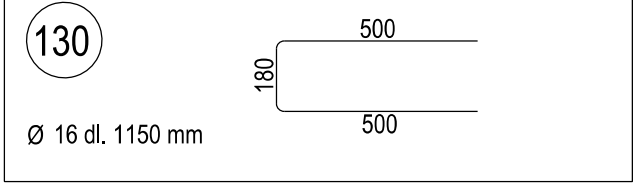
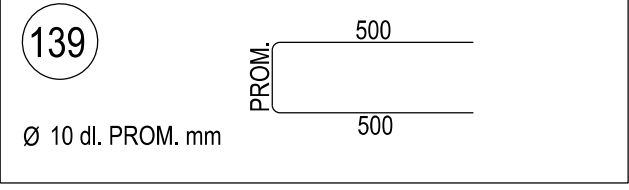
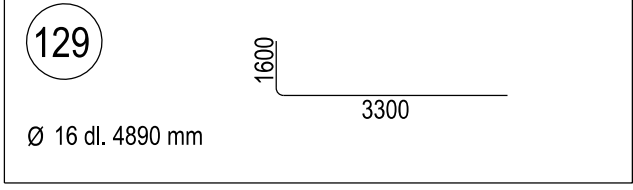
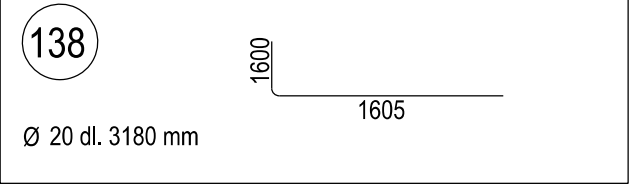
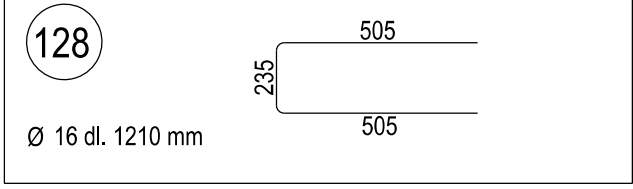
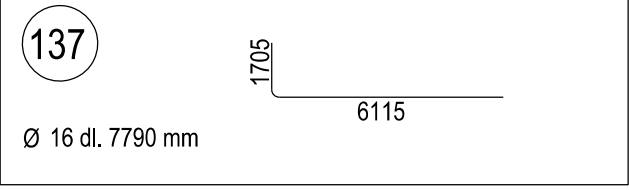
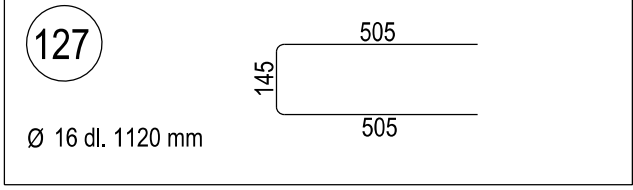
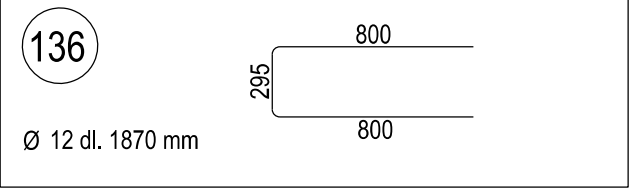
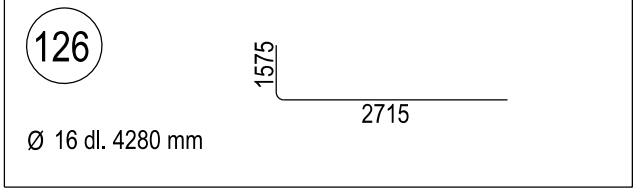
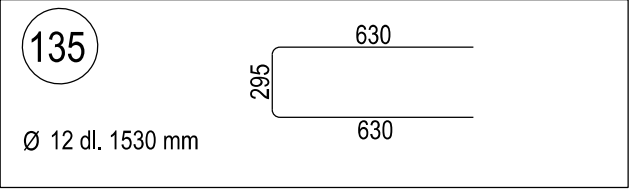
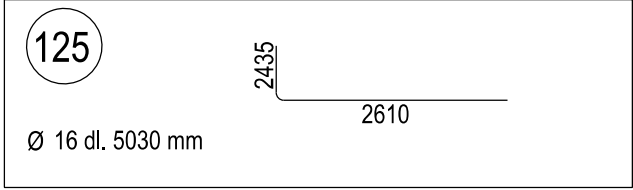
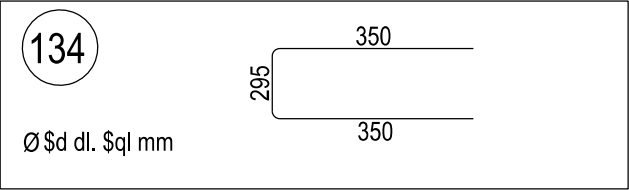
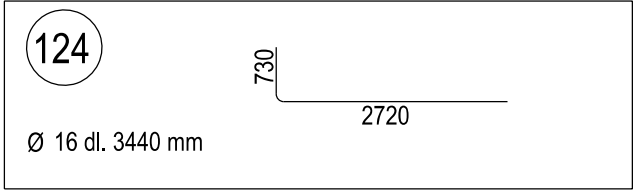
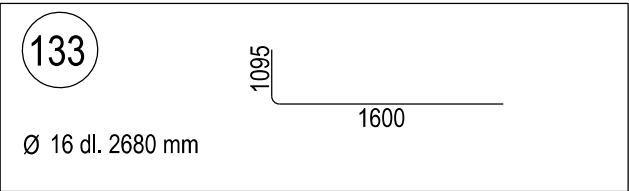
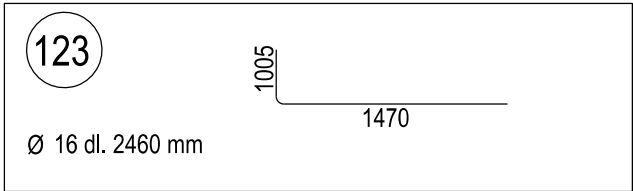
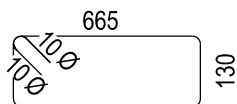

Ø 12 dl. 1750 mm

160

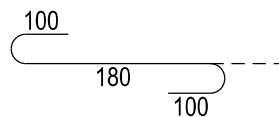

Ø 10 dl. 410 mm

151

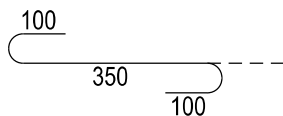

Ø 10 dl. 580 mm

168

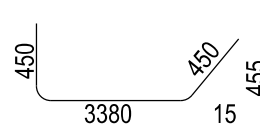

Ø 16 dl. 4250 mm

152

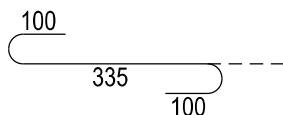

Ø 10 dl. 560 mm

153

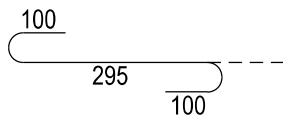

Ø 10 dl. 520 mm

154

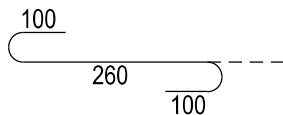

Ø 10 dl. 480 mm

155

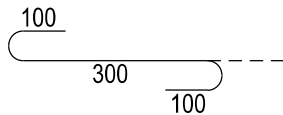

Ø 10 dl. 530 mm

156

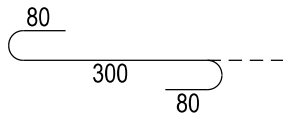

Ø 8 dl. 480 mm

157

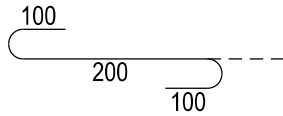

Ø 10 dl. 430 mm

158

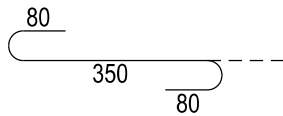

Ø 8 dl. 540 mm

159

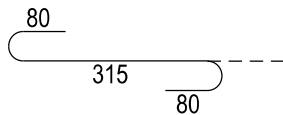

Ø 8 dl. 500 mm

PREMENNÉ POLOŽKY

66

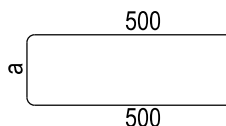

15 Ø 16

Celková Délka = 18,53 m

Tvar	Ks	Délka a [mm]	Délka prutu [m]	Délka celkem [m]
66a	2	240	1,21	2,42
66b	3	250	1,22	3,66
66c	2	260	1,23	2,46
66d	3	270	1,24	3,72
66e	3	280	1,25	3,75
66f	2	290	1,26	2,52

68

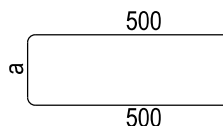

17 Ø 16

Celková Délka = 19,90 m

Tvar	Ks	Délka a [mm]	Délka prutu [m]	Délka celkem [m]
68a	2	230	1,20	2,40
68b	3	220	1,19	3,57
68c	2	210	1,18	2,36
68d	3	200	1,17	3,51
68e	3	190	1,16	3,48
68f	2	180	1,15	2,30
68g	2	175	1,14	2,28

72

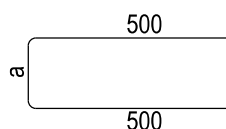

16 Ø 10

Celková Délka = 16,54 m

Tvar	Ks	Délka a [mm]	Délka prutu [m]	Délka celkem [m]
72a	2	85	1,06	2,12
72b	3	75	1,05	3,15
72c	3	65	1,04	3,12
72d	2	55	1,03	2,06
72e	3	45	1,02	3,06
72f	3	35	1,01	3,03

111

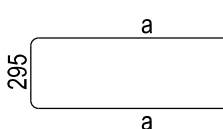

16 Ø 16

Celková Délka = 12,36 m

Tvar	Ks	Délka a [mm]	Délka prutu [m]	Délka celkem [m]
111a	1	285	0,83	0,83
111b	1	280	0,82	0,82
111c	2	275	0,81	1,62
111d	1	270	0,80	0,80
111e	1	265	0,79	0,79
111f	2	260	0,78	1,56
111g	1	255	0,77	0,77
111h	1	250	0,76	0,76
111i	2	245	0,75	1,50
111j	1	240	0,74	0,74
111k	1	235	0,73	0,73
111l	2	230	0,72	1,44

139

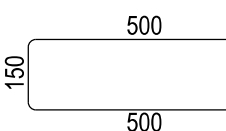

16 Ø 10

Celková Délka = 17,70 m

Tvar	Ks	Délka a [mm]	Délka prutu [m]	Délka celkem [m]
139a	3	150	1,13	3,39
139b	3	140	1,12	3,36
139c	2	130	1,11	2,22
139d	3	120	1,10	3,30
139e	3	110	1,09	3,27
139f	2	100	1,08	2,16

140

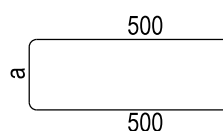

14 Ø 10

Celková Délka = 15,54 m

Tvar	Ks	Délka a [mm]	Délka prutu [m]	Délka celkem [m]
140a	3	150	1,13	3,39
140b	3	140	1,12	3,36
140c	2	130	1,11	2,22
140d	3	120	1,10	3,30
140e	3	110	1,09	3,27